

AS1 Series



Current Operated Switches

Applications

Electronic Proof Of Flow

- Current operated switch eliminates need for multiple pipe or duct penetrations.
- More reliable than electromechanical pressure or flow switches.

Conveyors

- Detects jams and overloads.
- Interlocks multiple conveyor sections.

Lighting Circuits

Easier to install and more accurate than photocells.

Electric Heaters

Faster response than temperature sensors.

MADE IN
USA

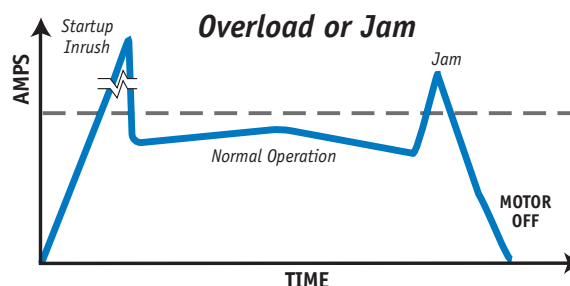
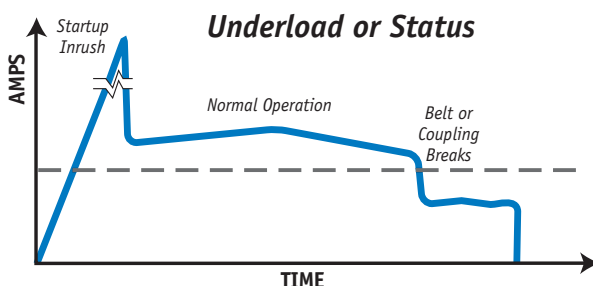
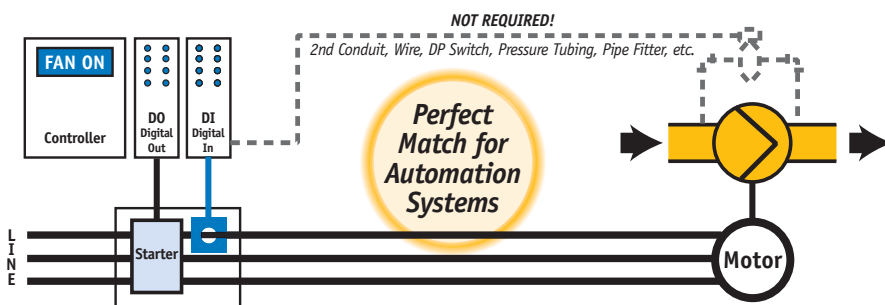

Current Operated Switches

AS1 Series

'AS1' Series Current Operated Switches from NK Technologies combine a current transformer, signal conditioner and limit alarm into a single package for use in status monitoring or proof of operation applications. Offering an extended setpoint range of 1-150A and universal, solid-state outputs, the self-powered AS1 can be tailored to provide accurate and dependable digital indication of over-current conditions across a broad range of applications. Available in solid-core enclosure styles or in a split-core case to maximize ease of installation.

Features

- **Universal Output**
 - N.O. or N.C. solid state switch for applications up to 240VAC/DC.
 - Compatible with most automation systems.
- **Self-powered**
 - Cuts installation and operating costs.
- **Easily Adjustable Setpoint**
 - Speeds startup.
- **Solid or Split-core Case**
 - Versions tailored for each installation.
- **Built-in Mounting Feet**
 - Simple, two-screw panel mount or attach optional DIN-rail brackets.
- **UL, CUL and CE Approval**
 - Accepted worldwide.

Specifications

Power Supply None — Self-powered
Output Magnetically Isolated Solid-State Switch

Output Rating ■ N.O. Version: 0.15A @ 240VAC or VDC
 ■ N.C. Version: 0.2A @ 135VAC or VDC
 ■ Not polarity sensitive

Off State Leakage < 10µA

Response Time 120 ms

Setpoint Range ■ Fixed Core: 1–150A
 ■ Split-core: 1.75–150A

Hysteresis 5% of Setpoint

Overload	MODEL	6 SEC	1 SEC
■ -GO (NOU)	500A	1,000A	
■ -GO (NCU)	400A	1,000A	
■ All Other	400A	1,000A	

Isolation Voltage UL Listed to 1,270VAC, tested to 5,000VAC

Frequency Range 6–100Hz

Sensing Aperture ■ -FF Case: 0.55" (14mm) dia.
 ■ -FT Case: 0.74" (19mm) dia.
 ■ -SP Case: 0.85" (21.6mm) sq.

Case UL 94V-0 Flammability Rated

Environmental -58 to 149°F (-50 to 65°C),
 0–95% RH, non-condensing

Listings UL 508 Industrial Control Equipment
 (USA & Canada), CE



Connections

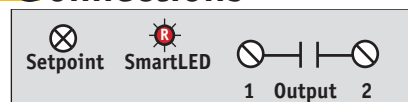

*Typical of
Models with LED*

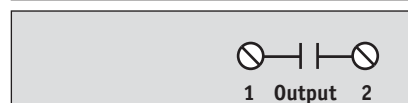

*Typical of
Go/No-Go Models*

Notes:

- Terminals are #6 screws.
- Normally open contacts shown (NOU).
- Normally closed contacts similar (NCU).

Ordering Information

Example: AS1-NOU-SP

Adjustable AC current operated switch, split-core, with indicating

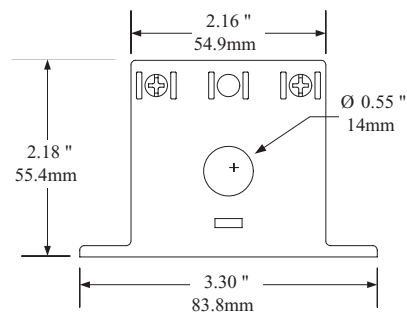
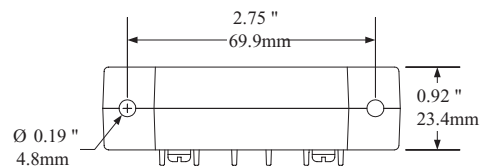
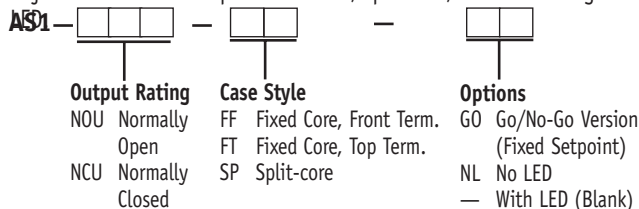

FF Case

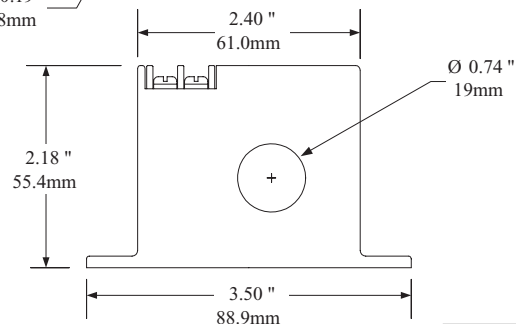
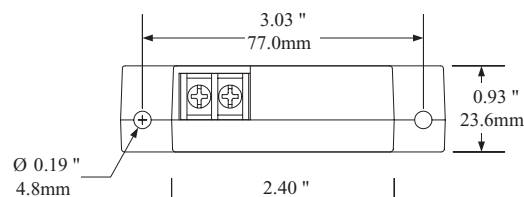

FT Case

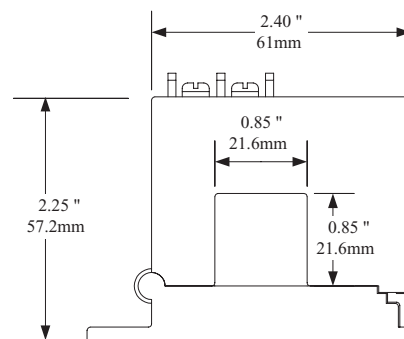
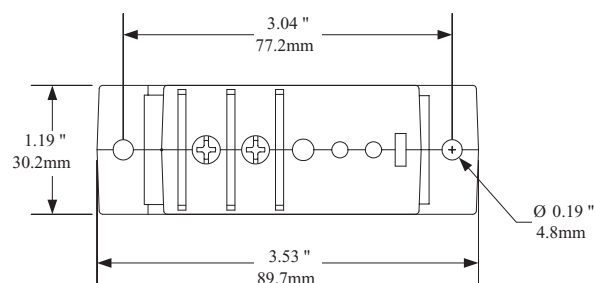

SP Case

Current Operated Switches

AS1 Series

PAGE 4