

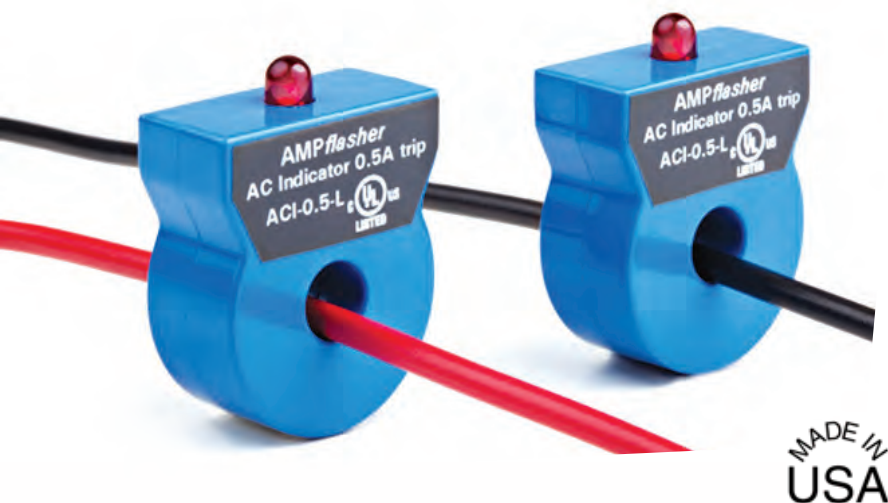

# NK Technologies

NK Technologies • 3511 Charter Park Drive • San Jose, CA 95136  
800.959.4014 • [www.nktechnologies.com](http://www.nktechnologies.com) • [sales@nktechnologies.com](mailto:sales@nktechnologies.com)



MADE IN  
USA

## AMPFlasher™ SERIES AC Current Indicators

### Specifications

<b>Output/Indication</b>	Standard: ● LED (flashing, red) Optional: ● 12" Pigtails for Remote LED ● N.O. solid-state relay 0.15A@135VAC/VDC*
<b>Indicating Range</b>	0.5A–100A
<b>LED On/Relay Trip Point</b>	<500mA (factory set)
<b>Dimensions</b>	● Overall: 1.125"W x 0.56"D x 1.5"H ● Aperture: 0.32"ID ● Pigtails: 12"
<b>Case</b>	UL94 V0 Flammability Rated
<b>Mounting</b>	Slides directly onto monitored conductor
<b>Environmental</b>	-58 to 122°F (-50 to 50°C) 0–95% RH, non-condensing
<b>Frequency Response</b>	50–400 HZ
<b>Listings/Certifications</b>	UL 508 Listed; RoHS Compliant



### Ordering Information

Sample Model Number: ACI-0.5-L  
Current Indicator with 0.5A sensitivity and red flashing LED.

ACI - (1) 0 . 5 - (2) L

(1) Sensitivity Level

(2) Indication/Output

0.5 500 mA

L LED (flashing, red)

The **AMPFlasher™ Series** Current Indicator is a compact, inexpensive, easy-to-use LED ring which slips onto a conductor to give a flashing indication of current flow. Ideal for use in control panels, or wherever confirmation of current flow is desired, AMPFlasher™ current indicators are a cost-effective way to detect live conductors and see current flow to fans, heaters, pumps, lighting or other powered devices.

### Features

#### Low Sensitivity Turn-On Point

- Detect currents as low as 0.5A with a single conductor pass, eliminates the need to wrap conductors through multiple times to increase sensitivity

#### High Visibility Flashing LED

- Flashing LEDs perform better in daylight conditions and from multiple angles than constant on LEDs

#### Choice of Outputs

- LED output standard, optional outputs include 12" pigtails for remote LED indication or N.O. solid-state contacts\*

### Applications

- Quick visual status of electric motor load.
- Identify open heater circuit connection.
- Provide panel mounted indication of current draw on monitored load.
- Confirmation of operation for critical lighting or equipment.

### Dimensions

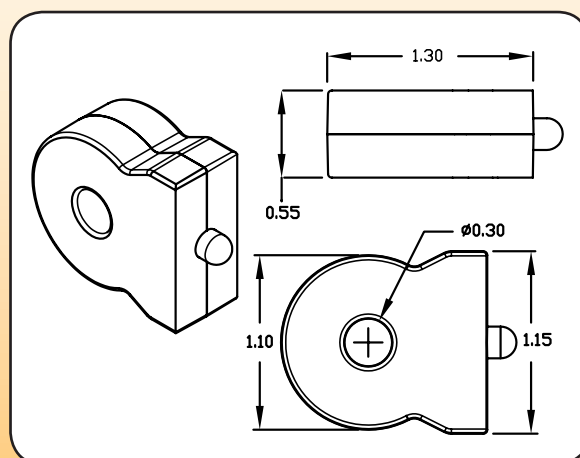

rev. 05/10